

### Mini Inline Key Switch Single Pole 2921



### Product Description

A range of Mini, Inline, Single Pole Key Switches available in bright chrome with a double D fixing hole shape. Once connected to a C.K. low voltage switch, these key switches can be used to control a single circuit. This makes it ideal for use in Enclosure applications or anywhere a circuit needs to be controlled by use of a key.

- **Standard movements:** key free 1, 4, 7
- **Lock combinations:** 200
- **Standard finish:** bright chrome
- **Fixing hole shape:** Double D
- **Switch Type Available:** C.K. (Low Voltage) Switch
- **Soldering Specification:** see [Technical Resources](#)

### Options

Product Code	Combinations	X Dimension	Indexing	Total Movement	Key Free	Body Length	Head Height	Head Width
2921-05-2A	200	22	90°	90°	1, 4	29.2	22	22
2921-12-2A	200	22	90°	180°	1, 4, 7	29.2	22	22
2922-01-2A	200	22	90°	90°	1	29.2	22	22

### Technical Drawing

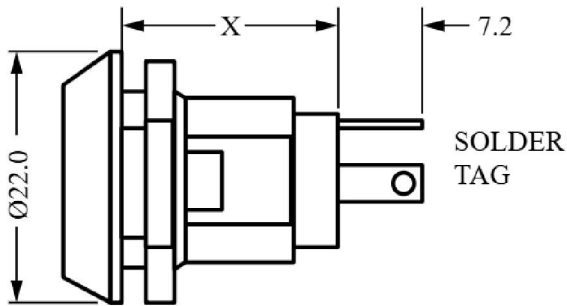

**SWITCH CONFIGURATION**

90° MOVEMENT

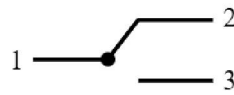

180° MOVEMENT

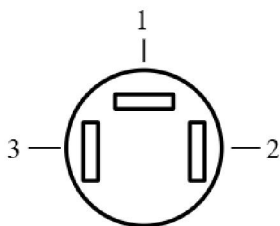
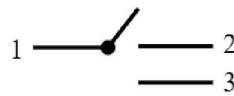

SOLDER TAG POSITIONS

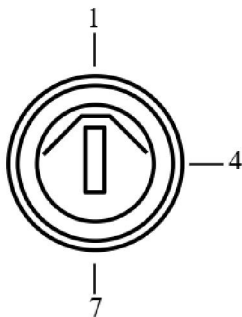

KEY FREE

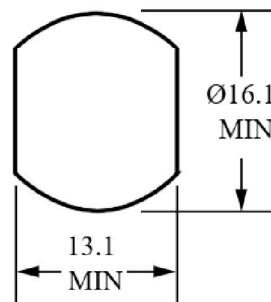

FIXING HOLE SIZE

**BELTRONICA**

Avenida de Somosierra, 22 - Naves E 6 y 7 - P. E. Inbisa I

San Sebastián de los Reyes - ES 28703 - Madrid

Tel / Phone: +34 916 381 331 - comercial@beltronica.es